

## How To Order a Replacement Axle Beam

Answers to the following questions will provide us with all of the necessary information to get your axle beam ordered and in your hands quickly. Make sure you have the answers to these questions close at hand when placing your order.

AXLE  
COMPONENTS

- 1) Spindles: Are they straight, drop or E-Z Lube?
- 2) Inner and Outer Bearings: What are the bearing numbers?
- 3) Seal: What is the I.D. and O.D. or Reference Number of the seal?
- 4) Tube: What is the outside diameter? Is the tube solid bar or tubular?
- 5) Hub Face: What is the measurement from center to center of spindles?
- 6) Spring Pads: What is the measurement from center to center of pads?
- 7) Brake Flange: What is the measurement from outside to outside of brake flanges?



### Tubular Axle Beams

Straight Spindle			4" Drop Spindle	
Part No.	Ref. No.	Description	Part No.	Ref. No.
T20BTR	169000	2,000 lb, 1 3/4" Round	N/A	N/A
T20BTR-EZ	169050	2,000 lb, 1 3/4" Round, w/ E-Z Lube	N/A	N/A
N/A	N/A	2,000 lb, 2 3/8" Round	TD20BTR	170400
N/A	N/A	2,000 lb, 2 3/8" Round w/ E-Z Lube	TD20BTR-EZ	170450
T3584F	169200	3,500 lb, 2 3/8" Round	TD3584F	170600
T3584F-EZ	169250	3,500 lb, 2 3/8" Round w/ E-Z Lube	TD3584F-EZ	170650
N/A	N/A	3,500 lb, 6" Drop, 2 3/8" Round	TD63584F	170800
N/A	N/A	3,500 lb, 6" Drop, 2 3/8" Round w/ E-Z Lube	TD63584F-EZ	170850
T60R42F	169410	6,000 lb, Regular Duty, 3" Round	TD60R42F	171010
T60R42F-EZ	169460	6,000 lb, Regular Duty, 3" Round, w/ E-Z Lube	TD60R42F-EZ	171050
T6042F	169600	6,000 lb, 3" Round	TD6042F	171200
T6042F-EZ	169650	6,000 lb, 3" Round, w/ E-Z Lube	TD6042F-EZ	171250
T70DX	169800	7,000 lb, 3" Round	TD70DX	171400
T70DX-EZ	169850	7,000 lb, 3" Round, w/ E-Z Lube	TD70DX-EZ	171450
T72DX	169900	7,200 lb, 3" Round	TD72DX	171500
T72DX-EZ	169950	7,200 lb, 3" Round, w/ E-Z Lube	TD72DX-EZ	171550
T80DX	170000	8,000 lb, 3 1/2" Round	TD80DX	171600
T80DX-EZ	170100	8,000 lb, 3 1/2" Round, w/ E-Z Lube	TD80DX-EZ	171605
T90DX7	170225	9,000 lb, 4" Round, 7 Bolt Flange	N/A	N/A
T10GD-DX7	170250	10,000 lb, General Duty, 5" Round, 7 Bolt Flange	N/A	N/A
T10HD-DX7	170275	10,000 lb, Heavy Duty, 5" Round, 7 Bolt Flange	N/A	N/A
T10HD-AIR	170300	10,000 lb, Heavy Duty, 5" Round, w/ Air Brake Spider	N/A	N/A

### Equation to Figure Hub Face from Flange to Flange Dimension

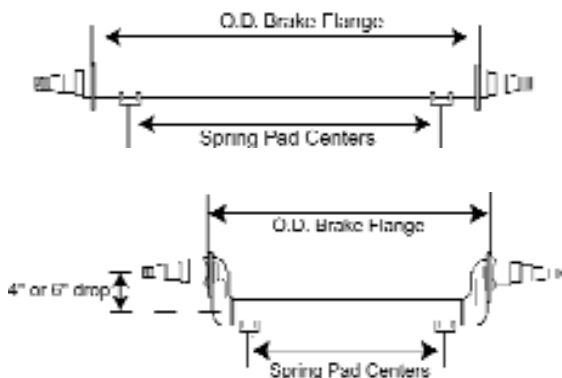

This chart is a handy guide for figuring the hub face dimensions, when you only have a bare beam with a flange from which to measure.

Axle Model	Equation
2K	Hub Face = Outside of flanges + 6.90
3.5K	Hub Face = Outside of flanges + 6.34
5.2LK (655)	Hub Face = Outside of flanges + 8.73
6K, 7K (865)	Hub Face = Outside of flanges + 8.73
5.2K - 6K w/ Demountable Hub	Track = Outside of flanges + 7.73
7.2K	Hub Face = Outside of flanges + 7.54
8K	Hub Face = Outside of flanges + 9.09
Old 9K	Hub Face = Outside of flanges + 10.46
9K, 10K General Duty	Hub Face = Outside of flanges + 13.50
10K Heavy Duty	Hub Face = Outside of flanges + 14.35
12K Low Profile	Hub Face = Outside of flanges + 21.77
12K High Profile	Hub Face = Outside of flanges + 15.27
15K	Hub Face = Outside of flanges + 17.45
10 on 11 1/4" Hub	Hub Face = Outside of flanges + 11.16
Tag Axle w/9-20 Drum	Hub Face = Outside of flanges + 17.19
Tag Axle w/9-32 Drum	Hub Face = Outside of flanges + 15.38

Note: These equations are valid for any axle where the same hub is used. For example, any hub that goes on a 3,500 lb. axle has a total flange to hub face difference of 6.34" regardless of whether it is a straight, drop or torflex

## Torflex Axle Beams

Std Grease			E-Z Lube	
Part No.	Ref. No.	Description	Part No.	Ref. No.
9TF20B	171620	#9 Torflex Beam, 2000 lb. Cap, no flange	9TF20B-EZ	171625
10TF35B	171630	#10 Torflex Beam, 3500 lb. Cap, w/ flange	10TF35B-EZ	171635
11TF60B	171640	#11 Torflex Beam, 6000 lb. Cap, w/ flange	11TF60B-EZ	171645
12TF70B	171650	#12 Torflex Beam, 7000 lb. Cap, w/ flange	12TF70B-EZ	171655
12VTF72B	171657	#12V Torflex Beam, 7200 lb. Cap, w/ flange	12VTF72B-EZ	171658
13TF80B	171660	#13 Torflex Beam, 8000 lb. Cap, w/ flange	13TF-80B-EZ	171670

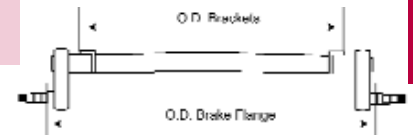

AXLE  
COMPONENTS

## Axle Spring Seats

Part No.	Ref. No.	Use With:
3-49	172600	1 3/4" Round Axle
3-43	172800	2 3/8" Round Axle
3-42	173000	3" Round Axle
3-48	173200	3 1/2" Round Axle
3-51	173400	4" Round Axle
3-72	173600	5" Round 10,000 lb Axles with 2 1/2" Wide Springs
3-66	173800	5" Round Axles w/ 3" Wide Springs



## Brake Mounting Flanges

Part No.	Ref. No.	Use With:	Brake Size	Hole I.D.
4-34	189200	1 3/4" Round Axle	7", 4 bolt	1.64"
4-35	189400	2 3/8" Round Axle	10", 4 bolt	2.27"
4-44-1	189600	3" Round Axle	12", 5 bolt	2.75"
721671	190000	2 1/4" Round, 2" Square Axles	12", 5 bolt	2.30"
4-50	190200	3 1/2" Round Axles	12 1/4" 8K, 4 bolt	3.01"
4-43-1	190600	5" Round Axles	10K, 12K, 15K, 6 bolt	4.08"
4-48	190800	5" Round Axles	10K, 12K, 15K, 7 bolt	4.17"



## Brake Mounting Bolts

Part No.	Ref. No.	Use With:	Brake Size	Length
7-225	190950	12" x 2" Brakes (#11 & #12 Torflex)	3/8"-16 Self-tapping	3/4"
7-5	191000	12" x 2" Brakes	3/8"-24	1 1/4"
7-75	191700	10" Brakes	7/16"-20	1 1/4"
7-116	192200	10K, 12K, 15K Brakes	7/16"-20	1 3/4"
7-97	192800	8K, 9K Brakes	1/2"-20	1 1/2"



## Brake Mounting Nuts and Lockwashers



Part No.	Ref. No.	Description	I.D.	Use With:
38N	077600	Nut	3/8"-24	12" Brakes
38LW	077800	Lockwasher	3/8"	12" Brakes
6-17	191800	Nut	7/16"-20	10" Brakes
5-8	192000	Lockwasher	7/16"	10" Brakes
6-92	192600	Locknut	7/16"-20	10K, 12K, 15K Brakes
6-46	193000	Locknut	1/2"-20	8K, 9K Brakes

## Replacement Spindle Washers

AXLE  
COMPONENTS



Plain Washer



D Washer



Tang type "A"  
Washer



Tang type "B"  
Washer



Tongue Washer

Part No.	Ref. No.	I.D.	Type
165863	166400	1"	Tongue Type for Replacement Spindles
5-70	166600	1 1/2"	Tongue Type for 9K & 10K GD
5-98	166800	2 5/8"	Tongue Type for 20K & 22.5K
5-99	167000	2 5/8"	Tang Type B for 20K & 22.5K
SW1000	167200	1"	Plain Type for Replacement Spindles
5-23	167400	1"	"D" Type for 3500 lb. & 6K Reg Duty
5-101	167600	1"	Tang Type A for E-Z Lube 2K to 8K (old style)
5-57	167800	1"	"D" Type 6K, 7K, 8K, (& 9K prior to 10/89)
5-147-1	167825	1"	42mm Nev-R-Lube, .25 x 2.25
5-149	167830	1"	50mm Nev-R-Lube, .31 x 2.50
5-150	167835	1"	35mm Nev-R-Lube, .25 x 1.88
165950	168000	1 1/2"	"D" Type, Inner Washer for 99 Spindle
165963	168200	1 1/2"	"D" Type, Outer Washer for 99 Spindle
5-71	168400	1 1/2"	Tang Type B for 9K & 10K GD
5-59	168600	1 3/4"	Tang Type B for 10K, 12K, & 15K
5-60	168800	1 3/4"	Tongue Type for 10K, 12K & 15K

## Replacement Spindle Nuts



Part No.	Ref. No.	Diameter	Description
165931	164600	7/8"-14	Castle Nut
165686	164800	1"-14	Castle Nut 2K thru 9K (9K prior to 10/89)
6-183	164900	1"-14	Self-locking, Dexter Nev-R-Lube
6-190	164925	N/A	Nut retainer for 6-191
6-191	164950	1" - 14"	Jam nut 2K through 8K (after Aug. 2003)
6-96	165200	1 1/2"-12	Nut for 9K & 10K GD
6-84	165400	1 3/4"-12	Nut for 10K, 12K & 15K
90623	165600	1 1/2"-12	Castle Nut for #99 Spindle
6-114	165800	2 5/8"-16	Inner Nut for 20K-25K
6-115	166000	2 5/8"-16	Outer Nut for 20K-25K

## Packaged Spindle Nut Kits



Part No.	Ref. No.	Description
RG05-020	163100	1"-14 SPINDLE NUT, PKG 2EA, WITH TONGUE WASHER & COTTER PIN
RG05-040	163110	1"-14 SPINDLE NUT, PKG 2EA, WITH D-WASHER & COTTER PIN
RG05-060	163120	1"-14 SPINDLE NUT, PKG 2EA, WITH TANG & D-WASHER, E-Z (OLD STYLE)
RG05-080	163130	1"-14 SPINDL NUT, PKG 2EA WITH PLAIN WSHR, COTTER PIN
RG05-100	163140	1"-14 SPINDL NUT, PKG 2EA W/RETAINER, DEX STD & E-Z (NEW STYLE)

## Spindles

Spindles come complete with spindle nut, washer and cotter key (tang washer supplied with grease lubed spindles). Note: Spindle dimensions shown are for identification purposes only and do not reflect min-max tolerances required for production of spindles.

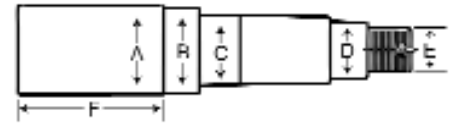

Part No.	Ref No.	Capacity	A	B	C	D	E	F	Description
R104BT8	163200	1000 lb	1.25	1.24	.99	.99	1.00	4.00	BT8
R104BTREZ	163325	1000 lb	1.25	1.50	1.06	1.06	1.00	4.00	BTR Grease Lube (zerk)
R104BT8-38	163400	1000 lb	1.38	1.24	.99	.99	1.00	4.00	BT8
R20484	163600	1750 lb	1.75	1.73	1.38	1.06	1.00	4.00	#84
R20384EZ	163725	1750 lb	1.75	1.73	1.38	1.06	1.00	3.00	#84 Grease Lube (zerk) & Flge
R2061/284	163800	1750 lb	1.75	1.73	1.38	1.06	1.00	6.50	#84
R50642	164000	2500 lb	2.25	2.24	1.74	1.25	1.00	6.00	#42
R50342EZ	164125	2600 lb	2.25	2.24	1.74	1.25	1.00	3.00	#42 Grease Lube (zerk) & Flge
SP204BT8	164200	1000 lb	1.50	1.24	.99	.99	1.00	4.00	BT8, 1.5" Square
SP20484	164400	1750 lb	1.50	1.73	1.38	1.06	1.00	4.00	#84, 1.5" Square
R40484	163930	1750 lb	2.00	1.73	1.38	1.06	1.00	4.00	#84

## Hub to Spindle Reference Chart

Use the following chart when matching hubs to spindles. Choose capacity, bolt pattern and desired shank size. Chart Lists spindle part number first, hub part number second.

1,000 lb. Capacity					
	Bolt Pattern	1 1/4" Round, 4" Long	1 3/8" Round, 4" Long	1 1/2" Square, 4" Long	1 1/4" Round, 4" Long, Lubed
Spindle Part No.	4 on 4"	R104BT8	R104BT8-38	SP204BT8	R104BTREZ
Hub Part No.		34822UC1	34822UC1	34822UC1	8-91-05UC1-EZ
Spindle Part No.	5 on 4 1/2"	R104BT8	R104BT8-38	SP204BT8	R104BTREZ
Hub Part No.		34822545UC1	34822545UC1	34822545UC1	8-259-5UC1-EZ

1,750 lb. Capacity					
	Bolt Pattern	1 3/4" Round, 4" Long	1 3/4" Round, 6 1/2" Long	1 1/2" Square, 4" Long	1 3/4" Round, 3" Long, Lubed
Spindle Part No.	5 on 4 1/2"	R20484	R2061/284	SP20484	R20384EZ
Hub Part No.		84545UC1	84545UC1	84545UC1	84545UC1-EZ
Spindle Part No.	5 on 4 3/4"	R20484	R2061/284	SP20484	R20384EZ
Hub Part No.		84545UC1	845475UC1	845475UC1	845475UC1-EZ
Spindle Part No.	5 on 5"	R20484	R2061/284	SP20484	R20384EZ
Hub Part No.		84545UC1	8455OUC1	8455OUC1	8455OUC1-EZ
Spindle Part No.	5 on 5 1/2"	R20484	R2061/284	SP20484	R20484EZ
Hub Part No.		84545UC1	84555UC1	84555UC1	84555UC1-EZ
Spindle Part No.	6 on 5 1/2"	R20484	R2061/284	SP20484	R20384EZ
Hub Part No.		84545UC1	84655UC1	84655UC1	84655UC1-EZ

2,500 lb Cap.			2,600 lb. Cap.		
	Bolt Pattern	2 1/4" Round x 6" Long 2,500 lb		Bolt Pattern	2 1/4" Round x 3" Long, Lubed
Spindle Part No.	6 on 5 1/2"	R50642			R50342EZ
Hub Part No.		42655UC1			8-213-5UC1-EZ
Spindle Part No.	8 on 6 1/2"	R50642			R50342EZ
Hub Part No.		42865UC1			8-231-9UC1-EZ